

4

3

2

1

REVISIONS			
DATE	REV.	DESCRIPTION	APPROVED
10/10/1991	A	PRODUCTION	TJD
01/29/1992	B	ECO #016	TJD
03/03/1994	C	ECO #116	WTV
01/01/1995	D	ECO #022	WTV
10/01/1997	E	ECO #024	WTV
02/03/1998	F	ECO #025	WTV
11/29/2017	G	ECO #335	W. Tomblin

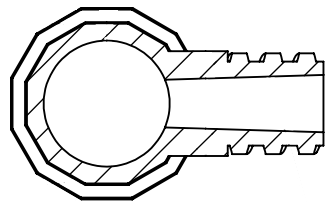
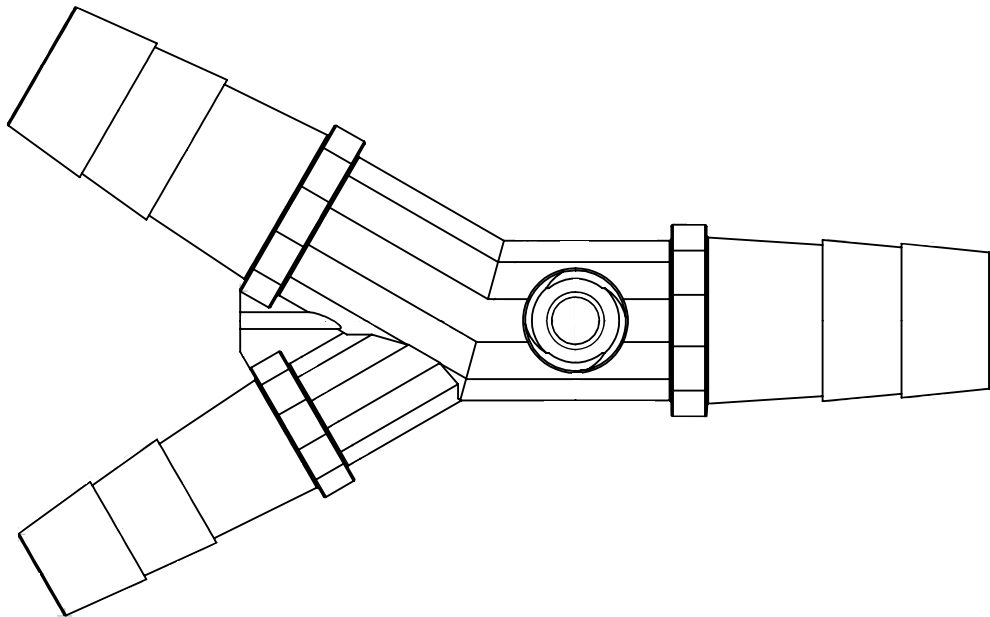
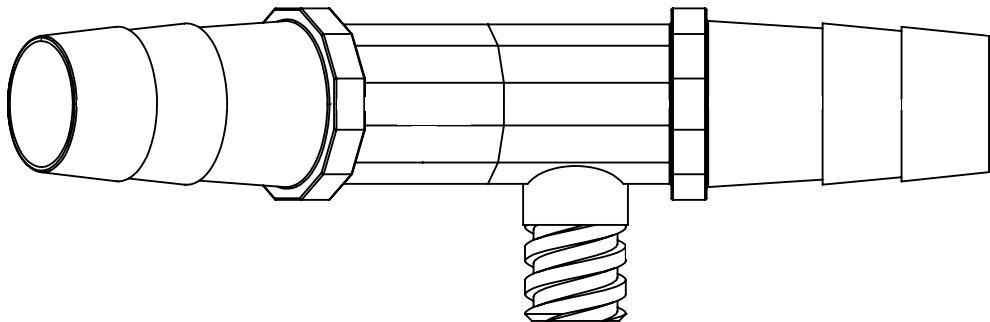

SECTION B-B

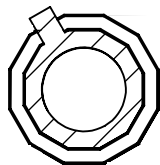
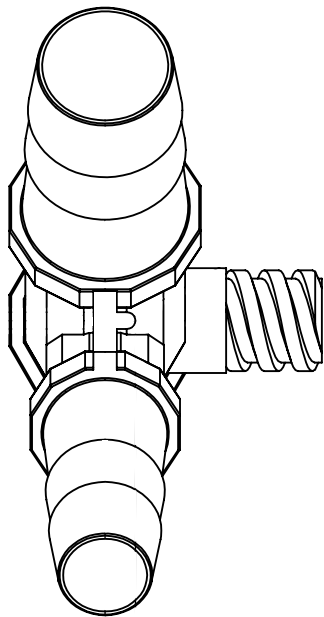

SECTION C-C

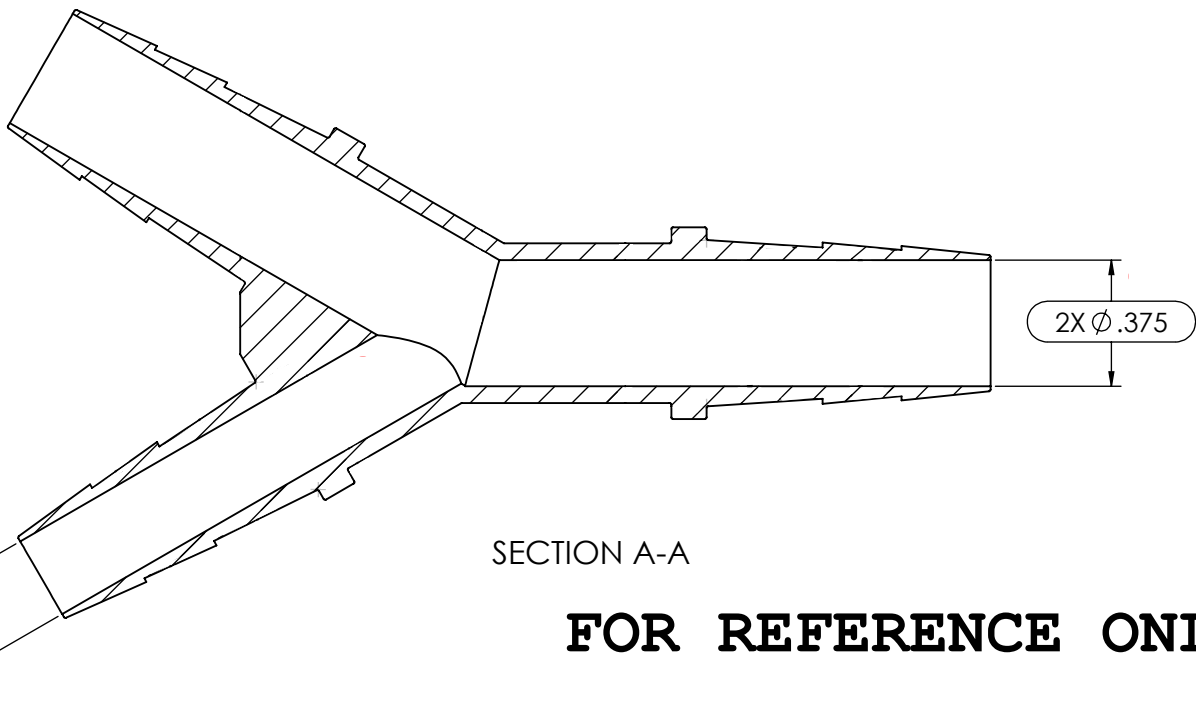

SECTION A-A

FOR REFERENCE ONLY

SEE NOTES 095

-03	2530-451118 POLYCARBONATE		
-01	2558-550115 POLYCARBONATE		
DASH NO.	DESCRIPTION		
UNLESS OTHERWISE SPECIFIED:	BREVET, INC. TITLE: .375 DIA. X .250 DIA. X 375 DIA. "Y" CONNECTORS WITH LUER		
DIMENSIONS ARE IN INCHES			
TOLERANCES:			
FRACTIONAL ±.015			
ANGULAR: .5° ±			
ONE DECIMAL ±.015			
TWO PLACE DECIMAL ±.010			
THREE PLACE DECIMAL ±.005			
INTERPRET GEOMETRIC TOLERANCING PER:			
MATERIAL			
APPROVED	ORDER NO.	DWG. NO.	REV
DO NOT SCALE DRAWING		140-**	G

4

3

2

1