

REVISIONS			
DATE	REV.	DESCRIPTION	APPROVED
10/22/1992	B	ECO #008 / 010	TJD
1/29/1991	C	ECO #016	TJD
1/1/1995	D	ECO #022	WTV
7/25/2007	E	ECO #229	F. GAUER

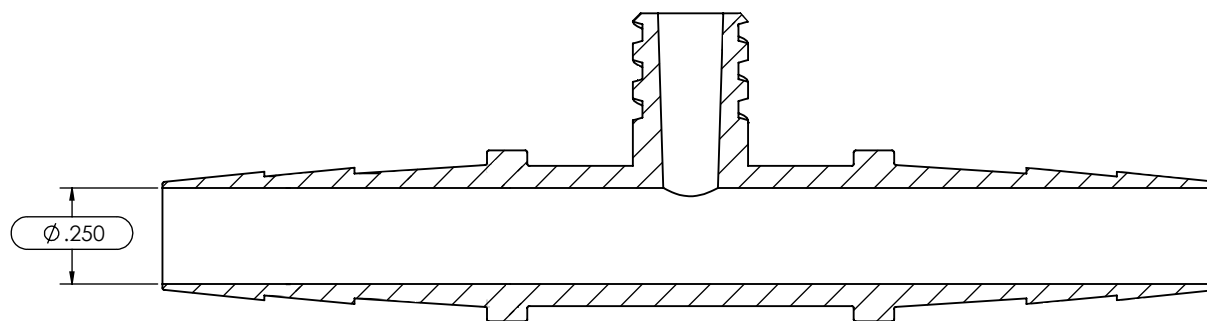
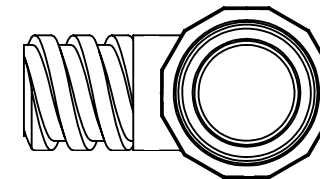
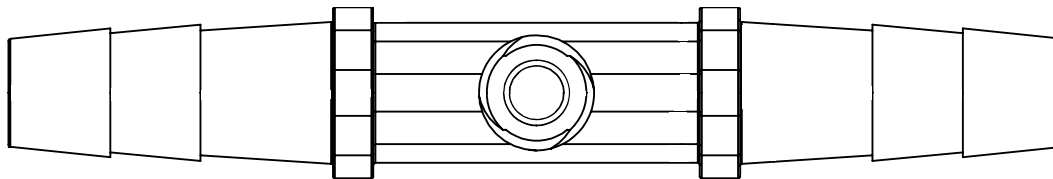

SECTION A-A

SEE NOTES 095

FOR REFERENCE ONLY

-03	RX2530-451118 POLYCARBONATE		
-01	2558-550115 POLYCARBONATE		
DASH NO.	DESCRIPTION		
UNLESS OTHERWISE SPECIFIED:		<div>BREVET, INC.</div> <div>TITLE:</div> <div>.250 DIA. STRAIGHT CONNECTOR WITH LUER</div>	
DIMENSIONS ARE IN INCHES			
TOLERANCES:			
FRACTIONAL ±.015			
ANGULAR: ± .5°			
ONE DECIMAL ±.015			
TWO PLACE DECIMAL ±.010			
THREE PLACE DECIMAL ±.005			
INTERPRET GEOMETRIC TOLERANCING PER:			
MATERIAL	ORDER NO.	DWG. NO.	REV
APPROVED		103-**	E

BREVET, INC.

TITLE:
**.250 DIA. STRAIGHT
CONNECTOR WITH LUER**